



Quick Start Guide



EOLife Connect is available on iOS and Android.
Stay tuned to be informed about application updates

HOME SCREEN

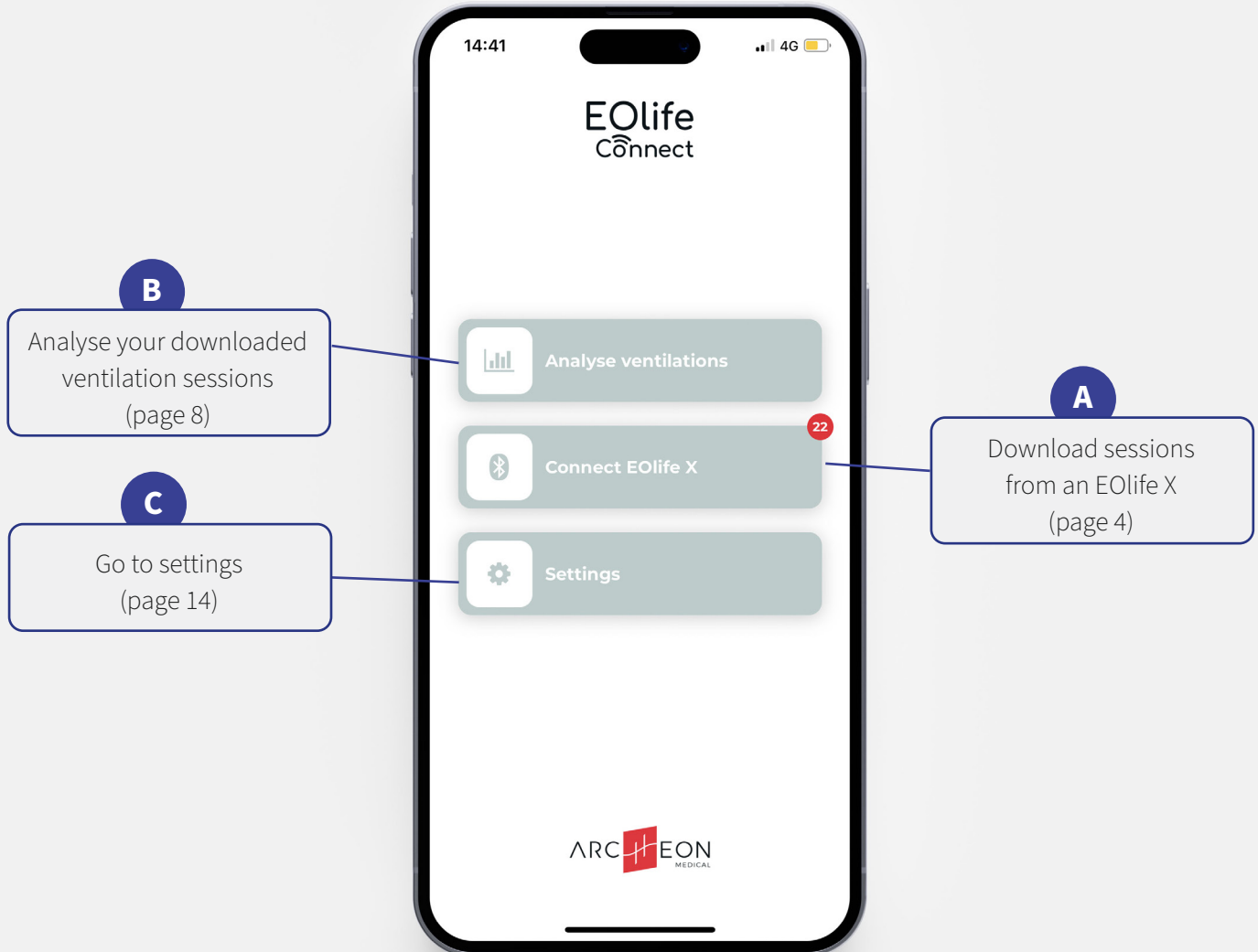

A

01. DOWNLOAD SESSIONS

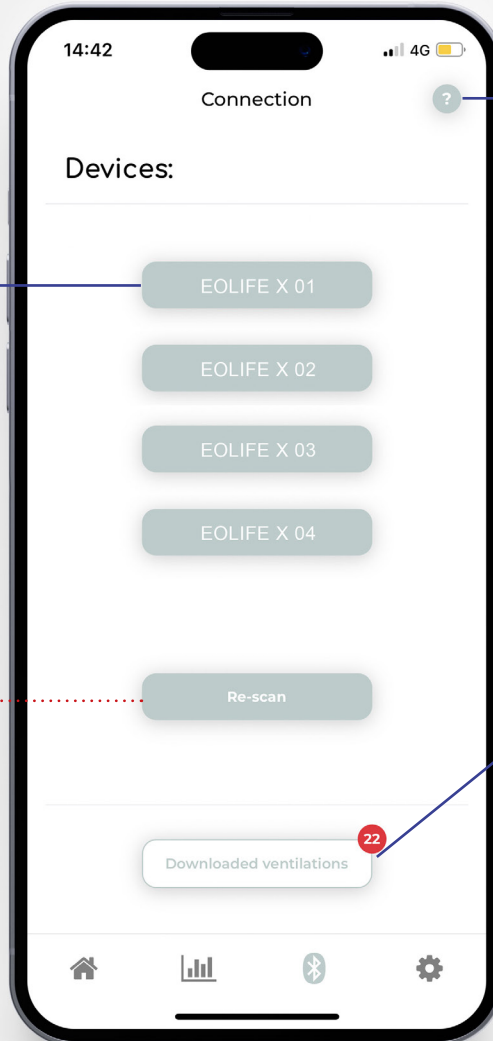

1

Select your EOLife X.

If your device doesn't appear in the list, press on re-scan

Download procedure (page 5)

2

Download all ventilation sessions from your EOLife X



BE CAREFUL !

Once imported in EOLife Connect, all your sessions will be deleted from your EOLife X.

02.DOWNLOAD PROCEDURE

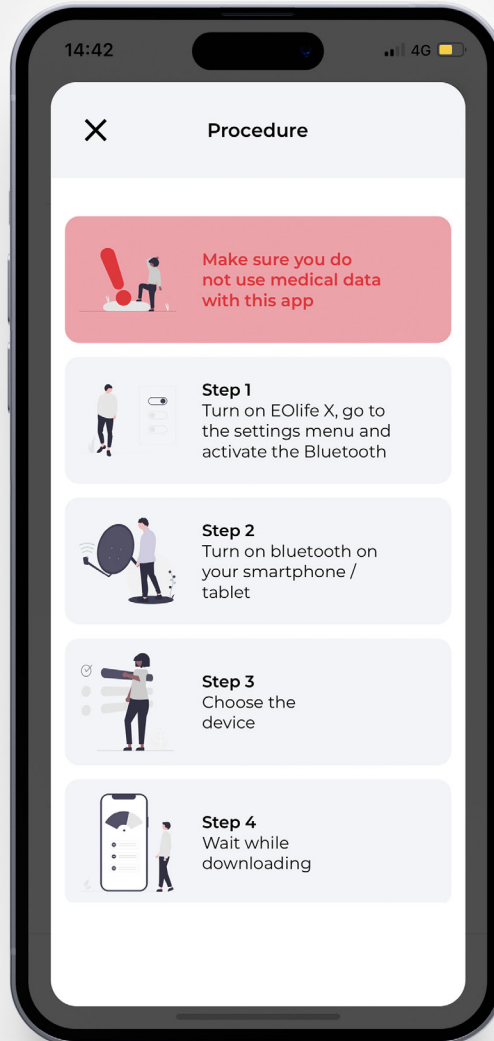
A

A

03.DOWNLOADED SESSIONS

1

Select a session. You can select multiple sessions by a long press on the screen.

Filter your list

2

Assign the session(s) to a user (page 7)

Deactivate the multiple selection

Delete all sessions (selected and unselected)

Delete the session (only with unique selection)

SN	Date	Time	Duration	Score
EOLife X0...	28/06/23	03:56 pm	00:00:05	50%
EOLife X0...	28/06/23	03:56 pm	00:04:10	3%
EOLife X0...	28/06/23	03:53 pm	00:01:44	0%
EOLife X0...	28/06/23	03:47 pm	00:02:32	0%

EOLife X0001...28/06/23	02:25 pm	00:05:54	0%	
EOLife X0001...28/06/23	02:19 pm	00:00:17	50%	
EOLife X0001...28/06/23	02:16 pm	00:00:12	100%	
EOLife X0001...28/06/23	02:15 pm	00:00:25	0%	
EOLife X0001...28/06/23	02:12 pm	00:00:35	71%	
EOLife X0001...28/06/23	02:10 pm	00:00:49	21%	

04.ASSIGN A USER

A

Select an existing user

Or create a new user

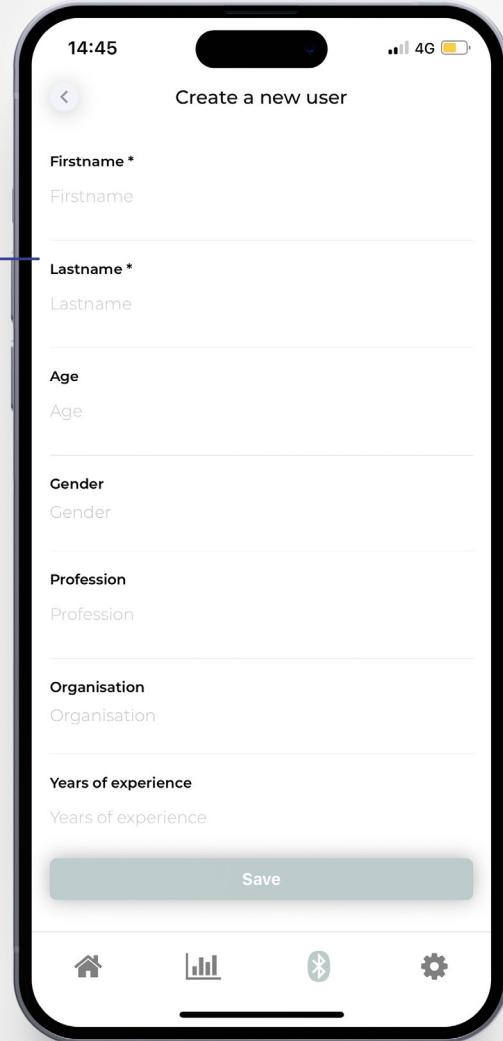
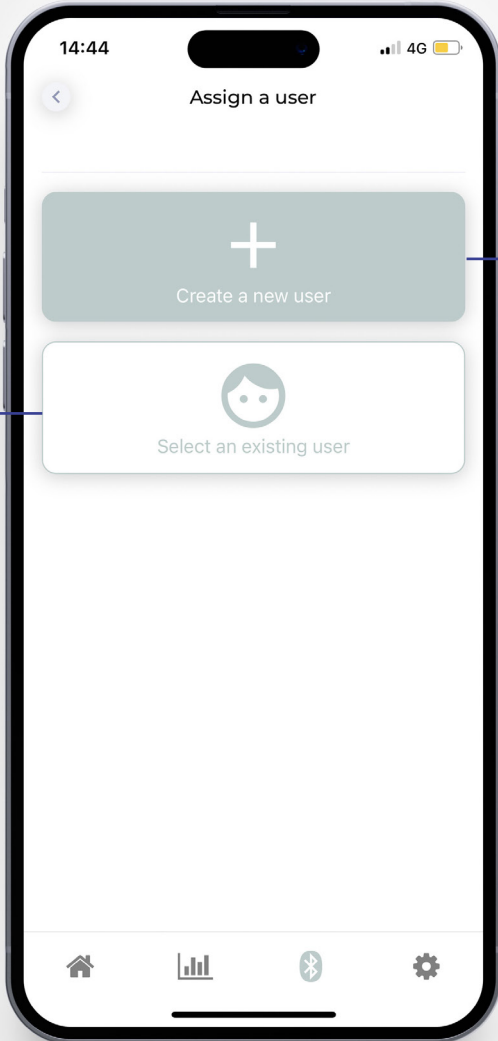

B

01.ASSIGNED SESSIONS

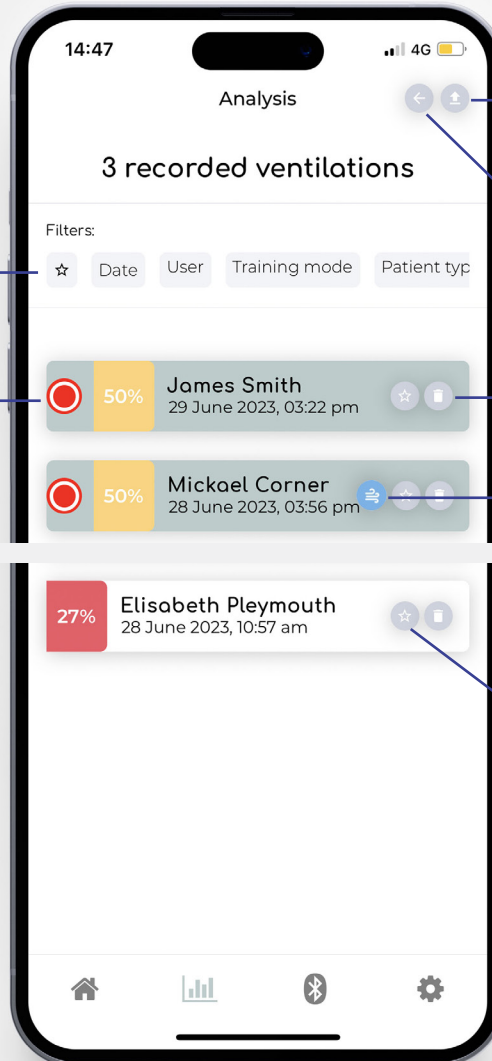

Filter your list

Select a session to see more details. (page 9)
You can select multiple sessions by a long press on the screen.

Download the CSV file(s) of the selected session(s)

Deactivate the multiple selection

Delete the session

The  icon indicates that the ventilation session was performed with «leakage alarm OFF». Therefore only Vi will be displayed.

Add the session to your Favorites

02.SESSIION DETAILS

B

14:48 4G

James Smith

Type	Age	Mode	Training
Child	1-2y	Continuous	Monitored
Frequency	ERC		

Parameters of the session

Ventilation quality breakdown (page 11)

Ventilation Frequencies (page 12)

Volume details (page 13)

Duration of the session

Download the CSV file of the session

Assign to another user

See student's progression (page 10)

Press to see more details

SCORE 50%

MEAN FREQUENCY 20/min

MEAN VT 55 mL

DURATION 00:00:05

NUMBER OF RECORDINGS 2

Home, Bar chart, Bluetooth, Settings

B

03.STUDENT PROGRESSION

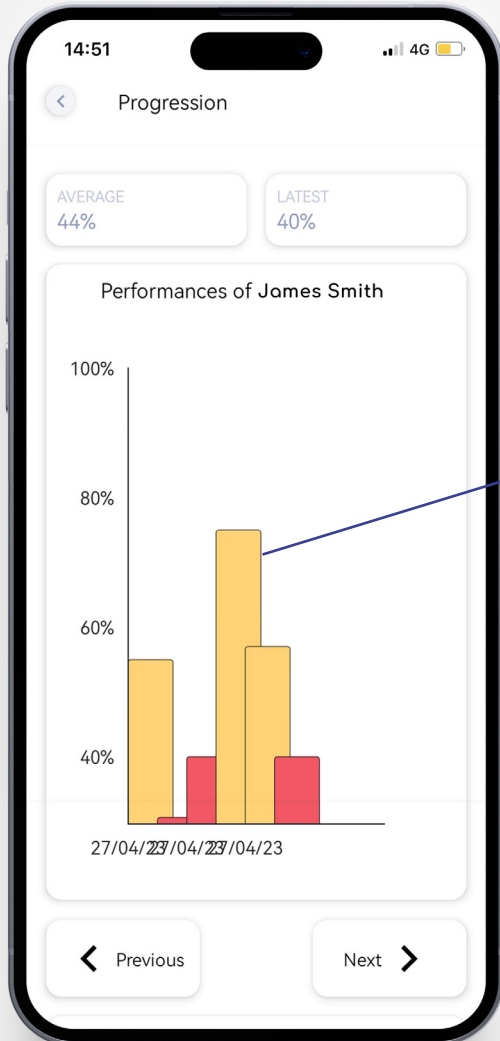

Press on previous or next to navigate the graph

Press on the bar to see more details

Visualize the quality of ventilation within sessions

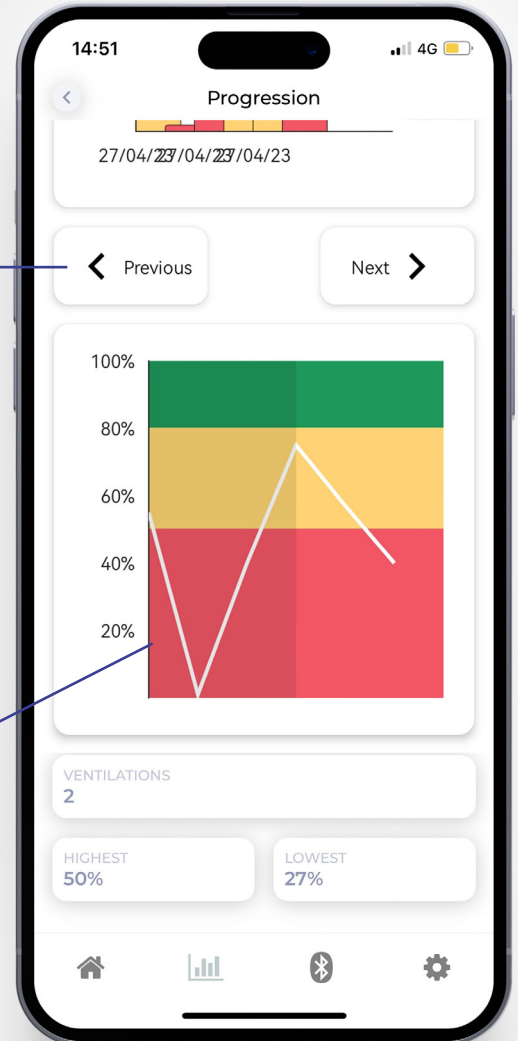

04. VENTILATION QUALITY BREAKDOWN

B

Press to see the percentage of each triggered alarms

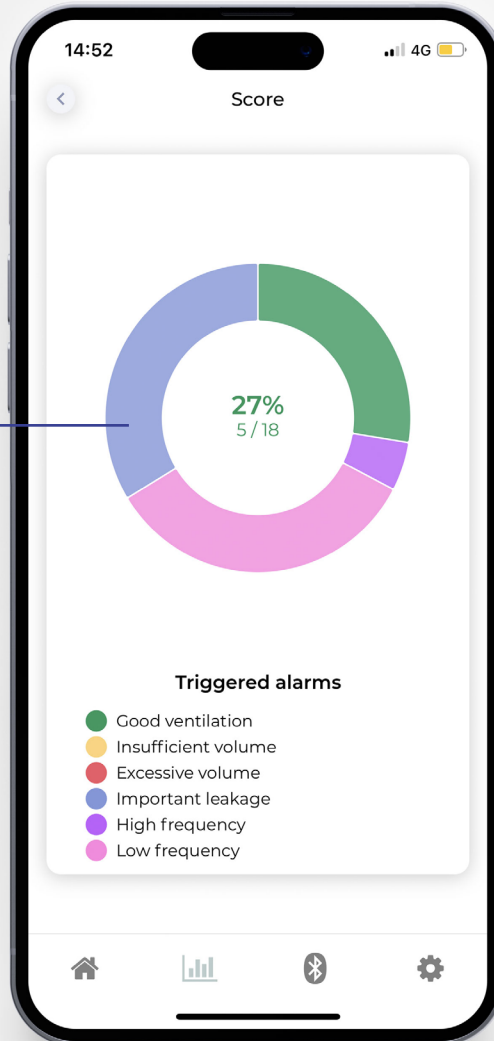

B

05. VENTILATION FREQUENCY

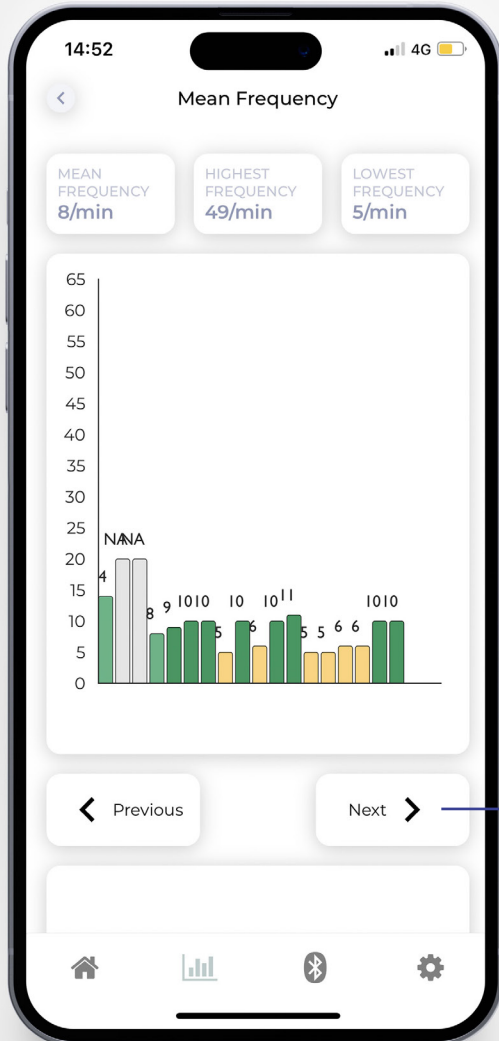

Press on previous or next to navigate the graph

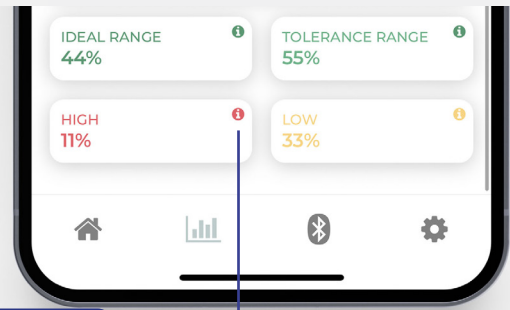

Press (i) to get more information about your results

Information

Excessive rate greater than 15 ventilations per minute prohibits the development of negative intrathoracic pressure during chest wall recoil, inhibiting venous blood return to the right heart and thereby decreasing the hemodynamic effectiveness of CPR. Studies have demonstrated that increasing ventilation rate from 12 to 30 breaths per minute impaired the chance of survival by 70%.

<https://www.ahajournals.org/doi/10.1161/01.cir.0000126594.79136.61>

06.VOLUME DETAILS

B

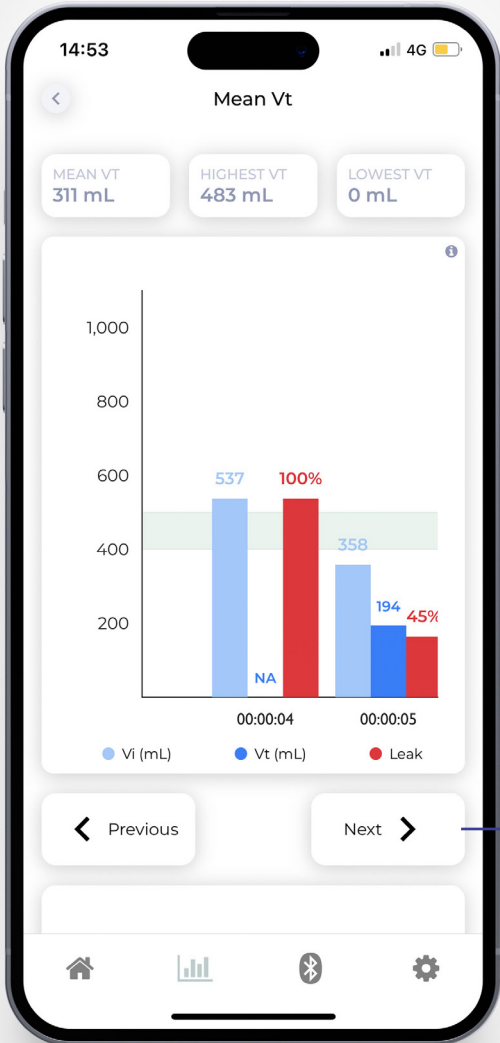

Press on previous or next to navigate the graph

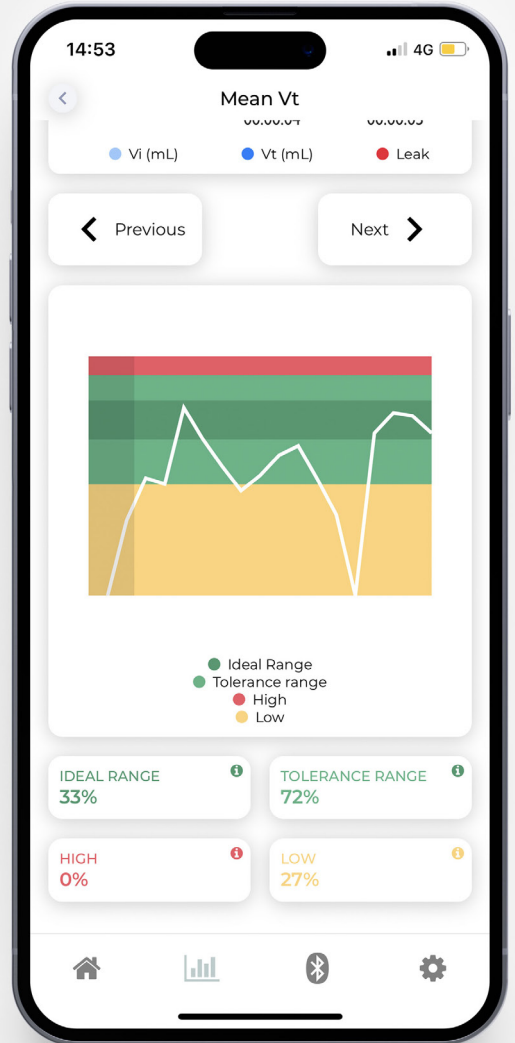

C

01.SETTINGS

Add, modify or delete users

Privacy Policy, legal notice

Who is Archeon medical ?

Read the FAQ or contact us by email for any question

Restore EOLife Connect database (page 16)

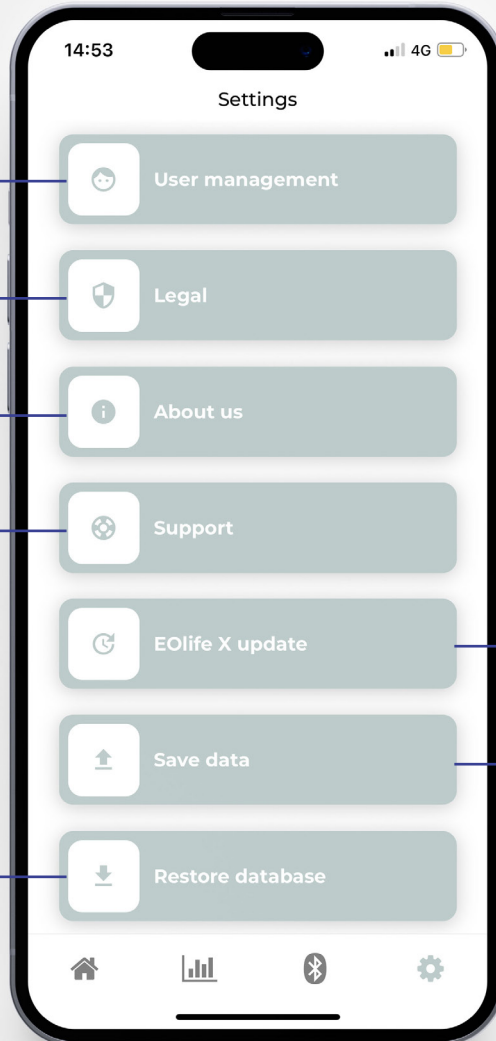

Update your EOLife X (only available on tablet)

Backup all your recorded sessions on your mobile/ tablet (page 15)

02.SAVE YOUR DATA

C

This feature can be used before changing your device.

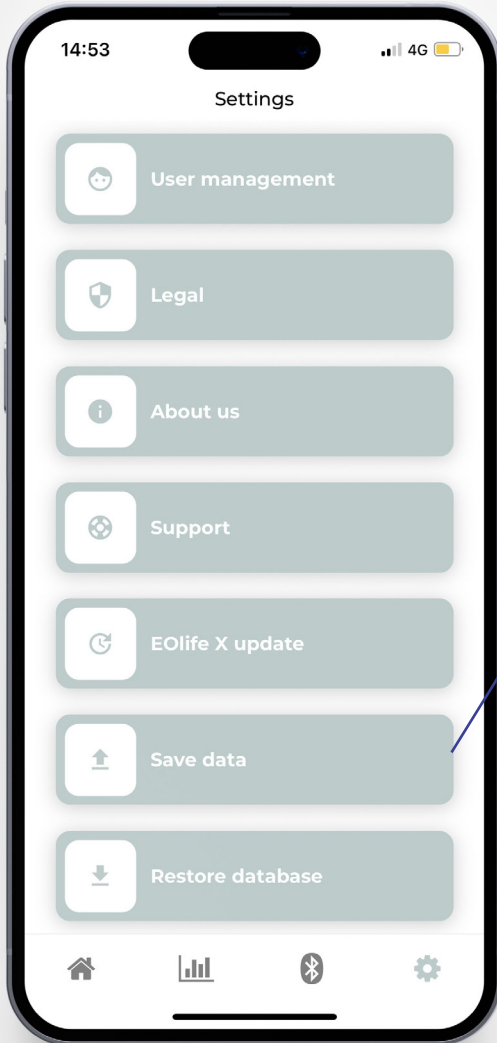

Press on 'Save data' and press on 'Yes'

Your entire EOLife Connect database will be saved onto your phone or tablet in a specific folder under the name:
eolife-connect-db-backup-{year}-{month}-{day}-{time}.json

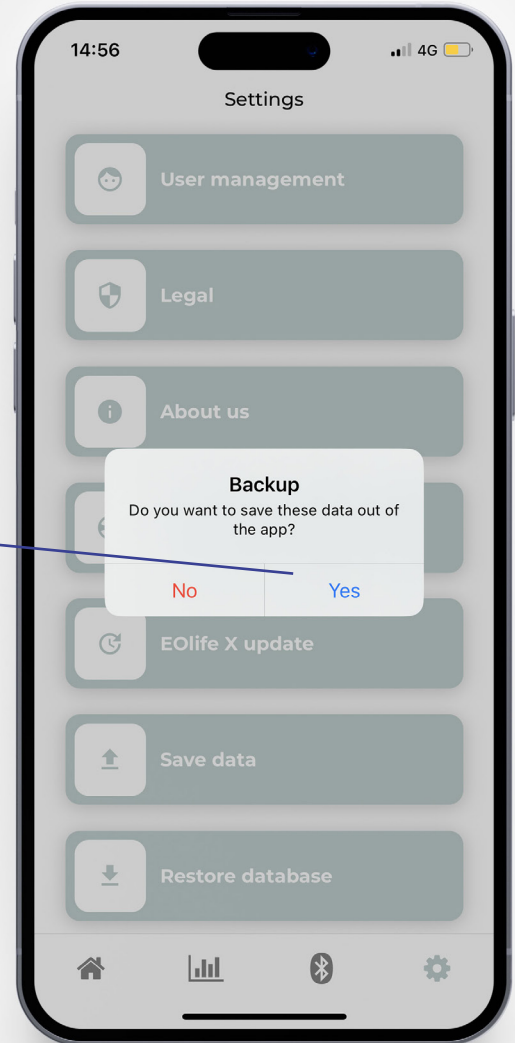

C

03.RESTORE DATABASE

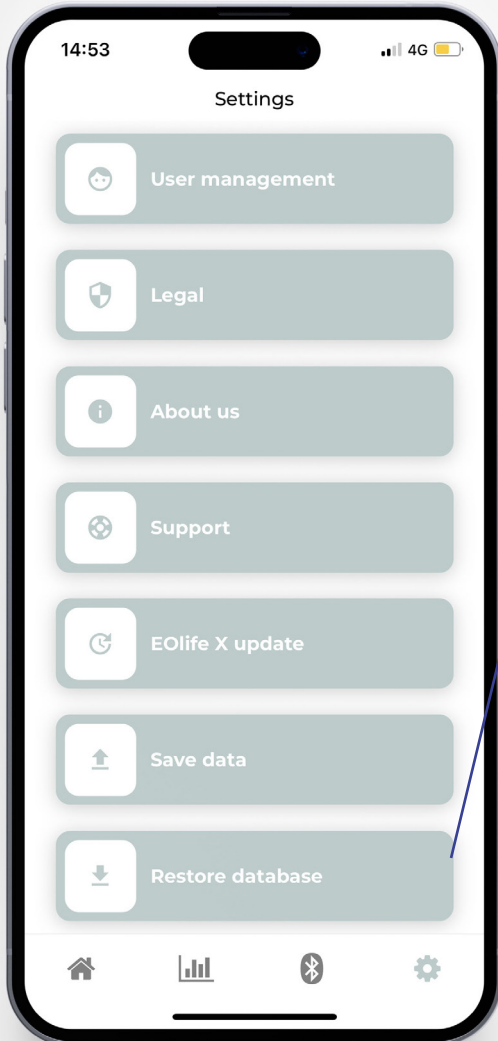

Press on 'Restore database' and press on 'Yes'.
On your mobile/tablet select a 'json' file in your mobile/tablet.

**WARNING !**

Your EOLife Connect database will be overwritten by imported data. Make sure to perform a backup before restoring the database

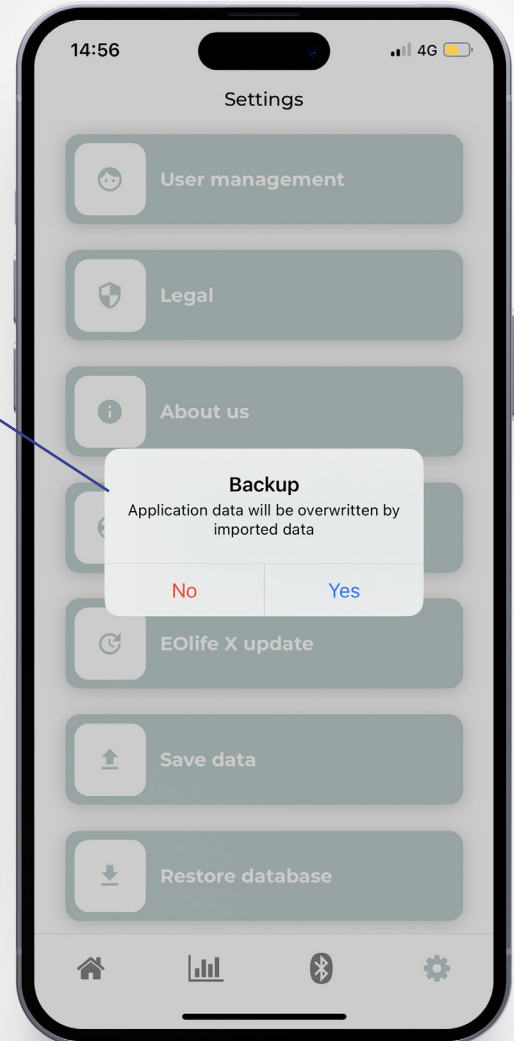



Copyright © 2023 Archeon Medical - All rights reserved

Version : 01 - November 2023

Archeon Medical - 2 chemin des aiguillettes - 25000 Besançon - FRANCE

Tel +33 (0)3 81 66 23 80 - www.archeon-medical.com